

Note: 901045-10 Multi-Function Base is designed to support one threaded rod and/or two stacks of Snap-in Cable Hangers to round or angle members at cell sites.

STEP 1: Attach Threaded Rod (sold separately) to Snap-in Support Base (Torque greater than 10 ft-lb). Use existing site hardware or new Threaded Rod Kit (PN's: 900210-10, 900211-10, 900212-10, 900381-10). (OMIT THIS STEP IF NOT SECURING A THREADED ROD.)

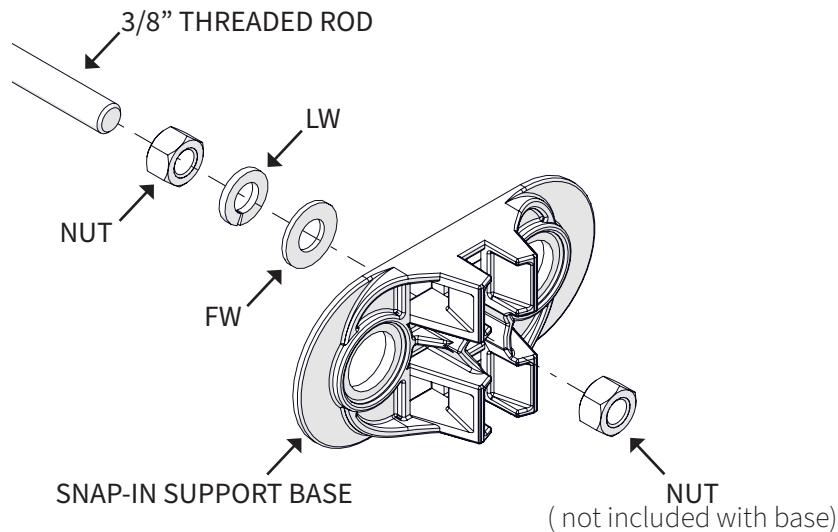

STEP 1

STEP 2: Secure Snap-in Support Base to a round or angle member using Cable Strap(s) (PN's: 900443-16-50 or 900443-27-25). Use Strap Tensioning tool (900442 or equivalent) to tighten Cable Strap(s). Trim Strap(s) flush to Locking Head.

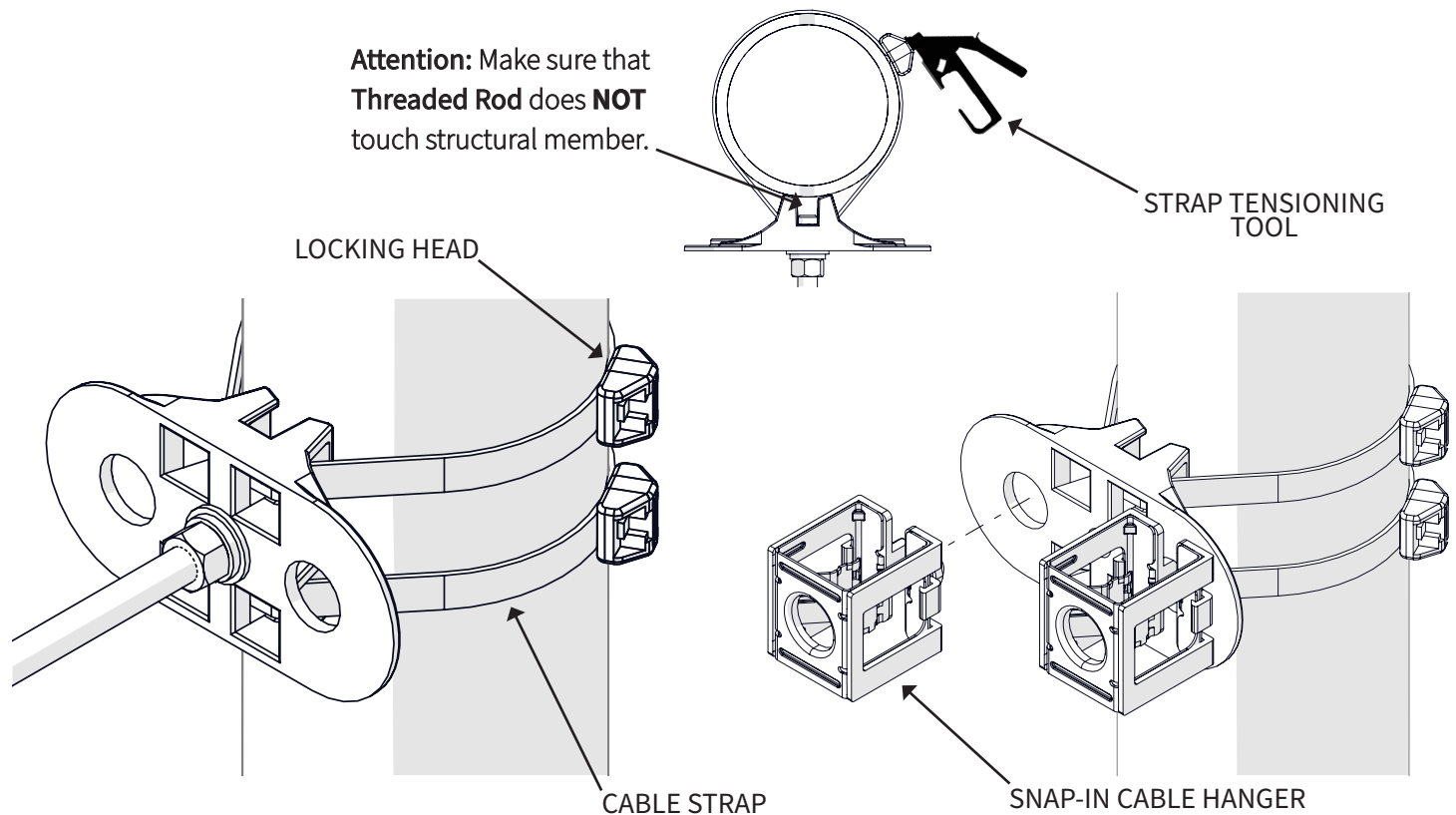

STEP 2

STEP 3

STEP 3: Install low PIM stackable Snap-in Cable Hangers (sold separately, PN's: PSHS-xxxx-10 or PSPS-xxx-10) as required into mounting holes provided. Maximum stack height = 3.